

## COLONNA DISPENSA

**POSIZIONARE I FIANCHI SU DEL CARTONE  
ED AVVITARE I TIRANTI**

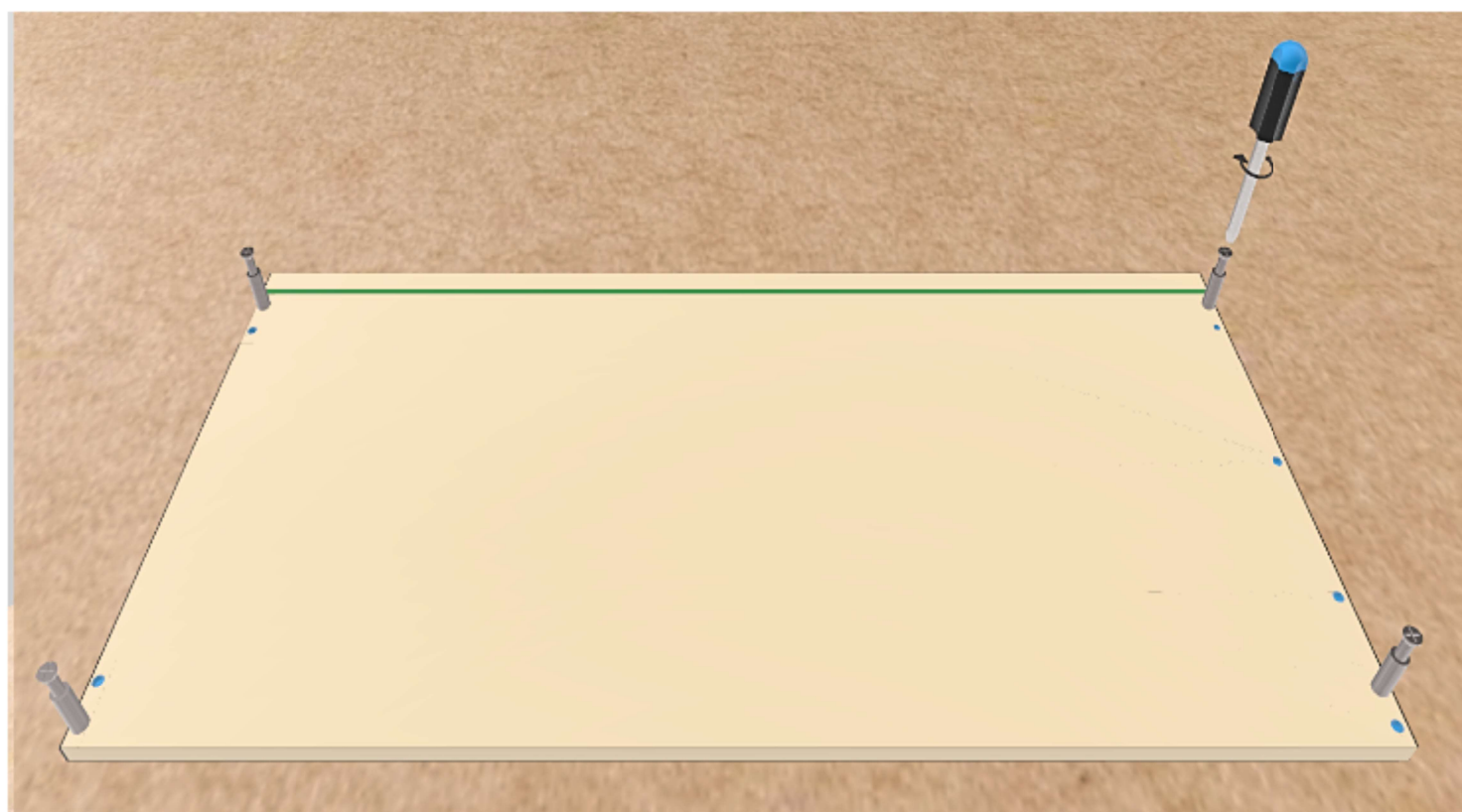

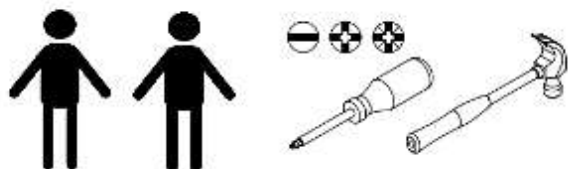

## INCASTRARE LE PARTI E BLOCCARLE

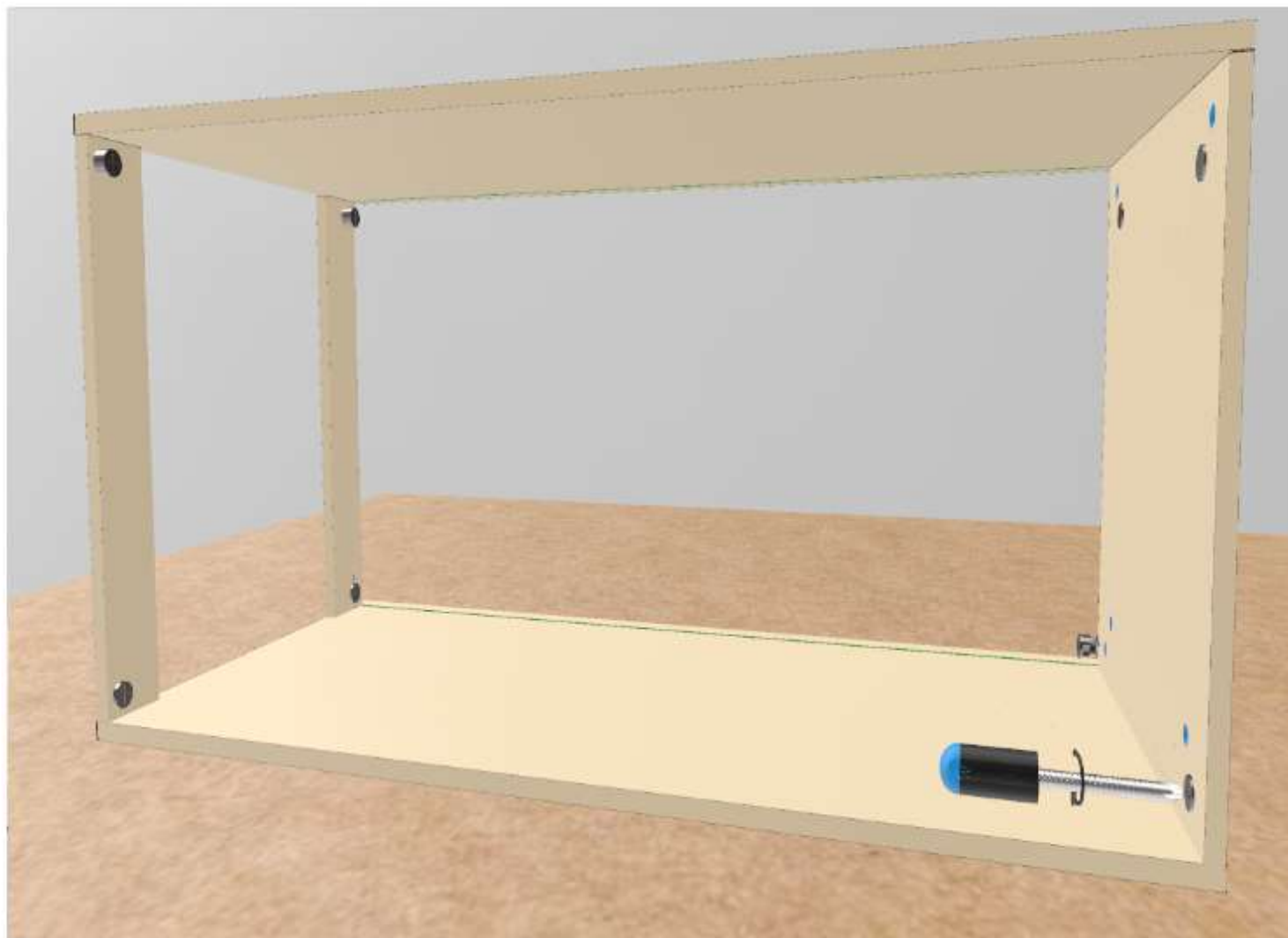

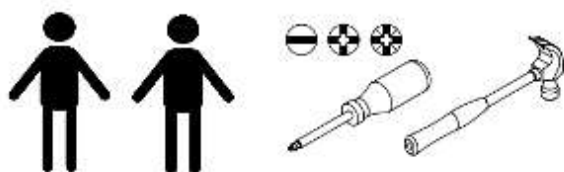

## INFILARE LA SCHIENA E METTERLA A SQUADRO CON LA STRUTTURA

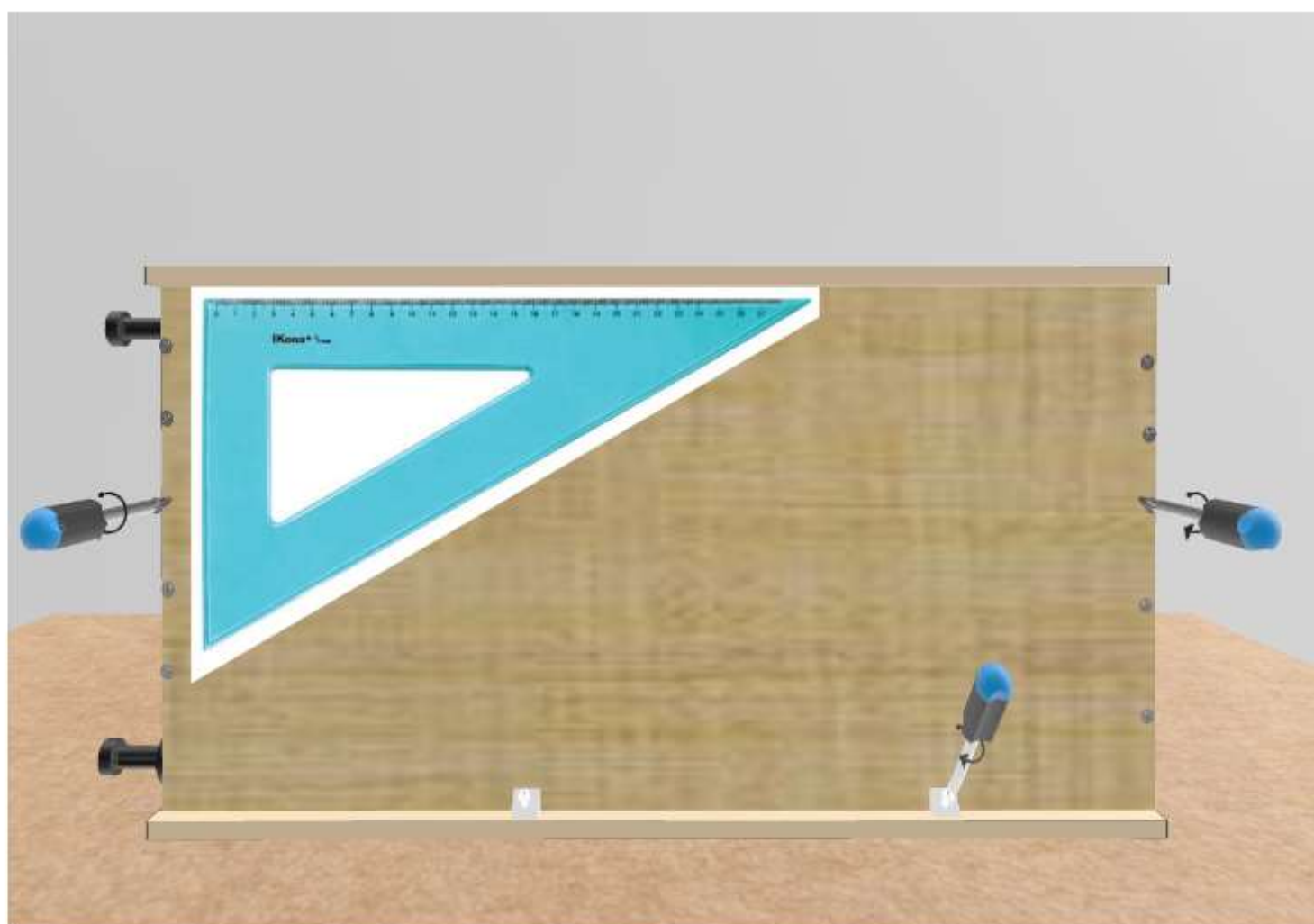

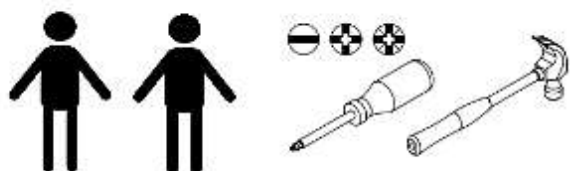

## AVVITARE LA SCHIENA ALLA STRUTTURA

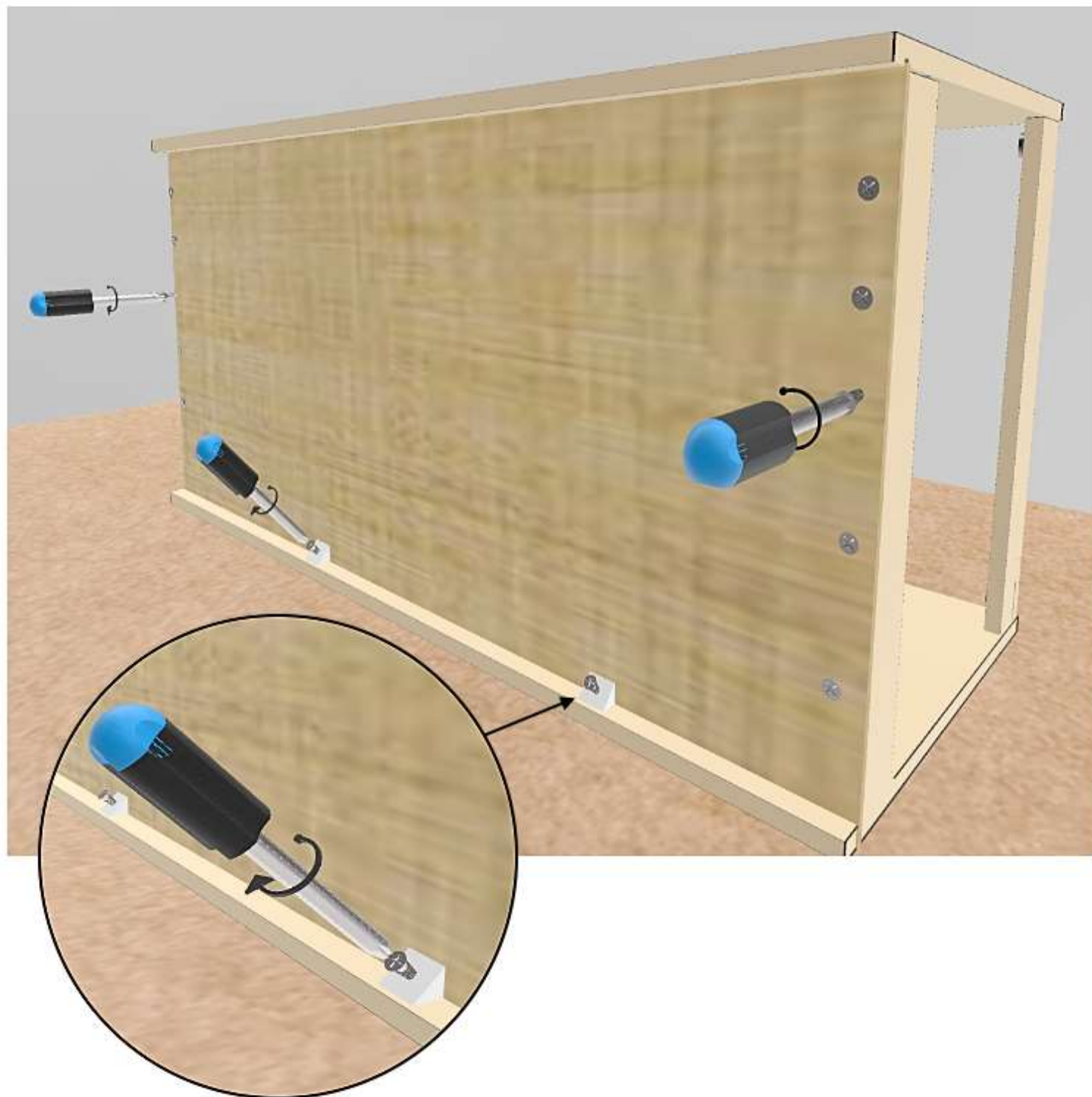



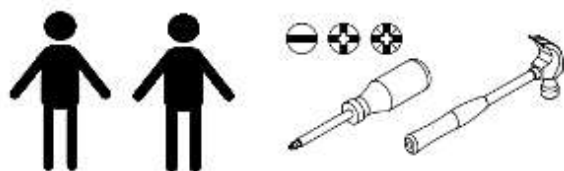

## AVVITARE LE CERNIERE REGOLABILI

