

CUBOTTO CON ANTA

**POSIZIONARE I FIANCHI SU DEL CARTONE ED
AVVITARE I TIRANTI**

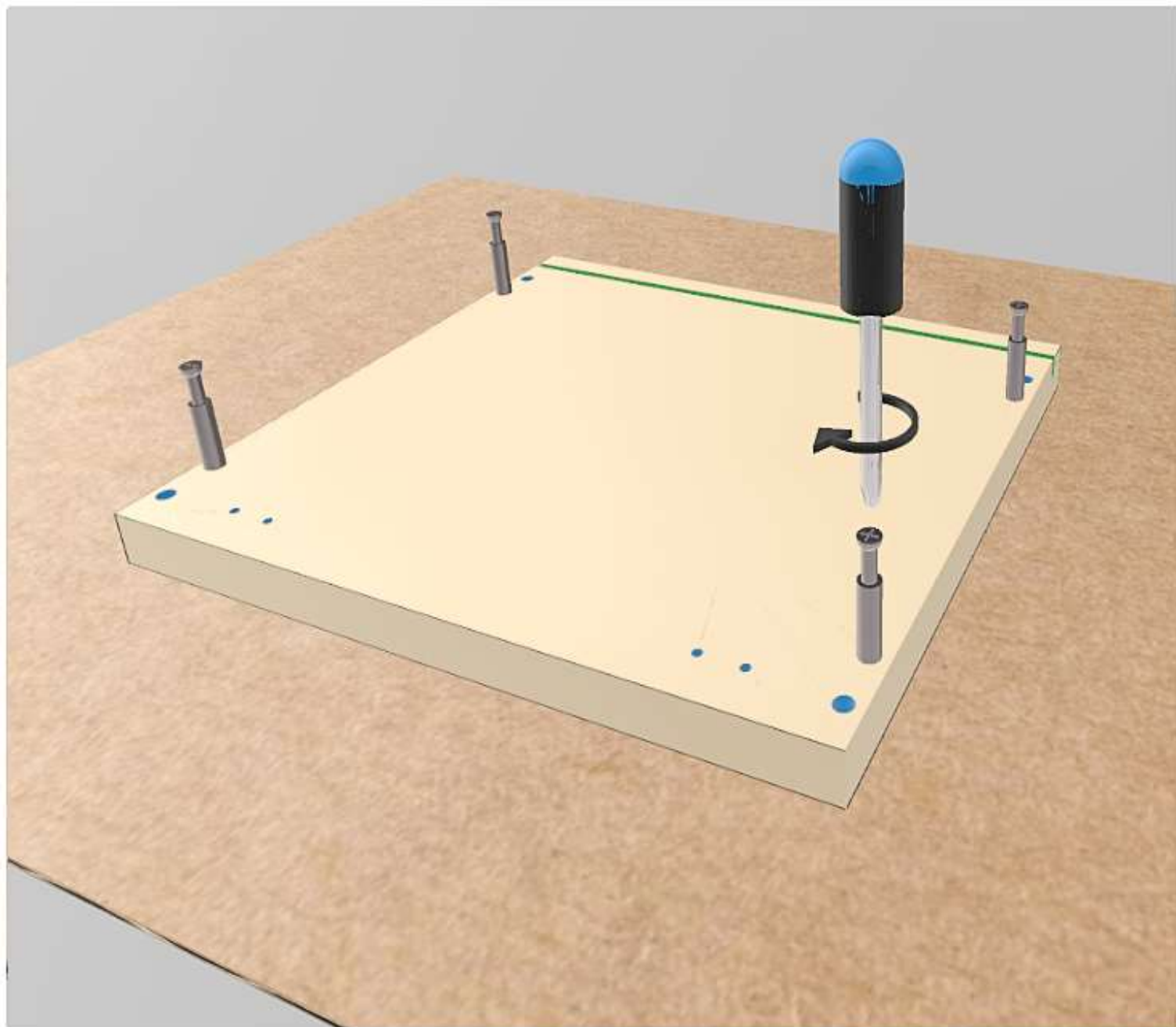



INFILARE I PANNELLI E BLOCCARLI

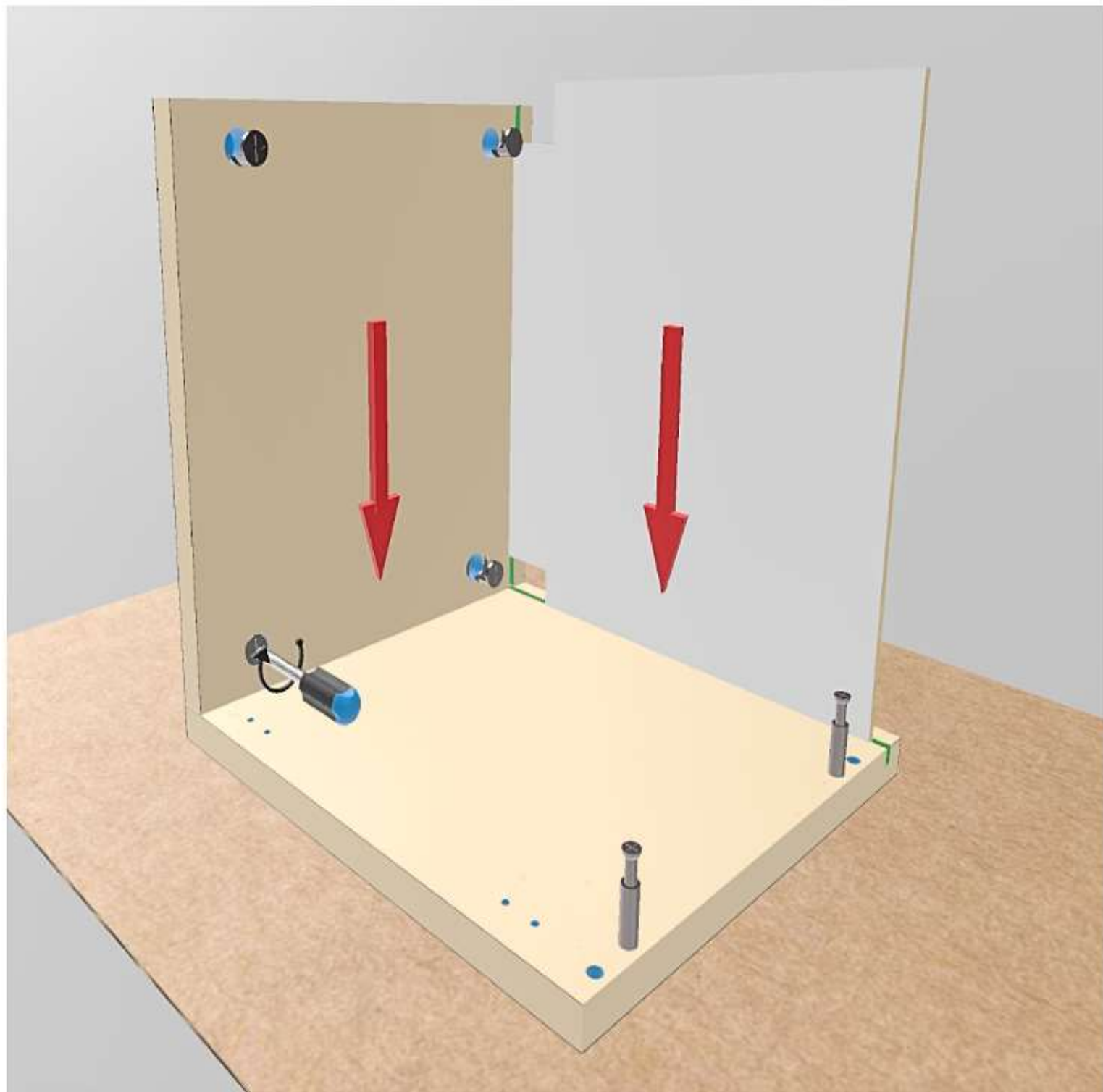

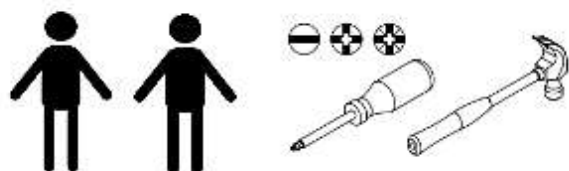

AVVITARE I REGGI PENSILE REGOLABILI



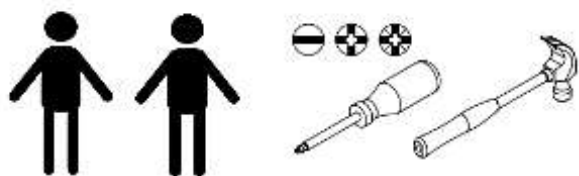

AVVITARE LE CERNIERE REGOLABILI

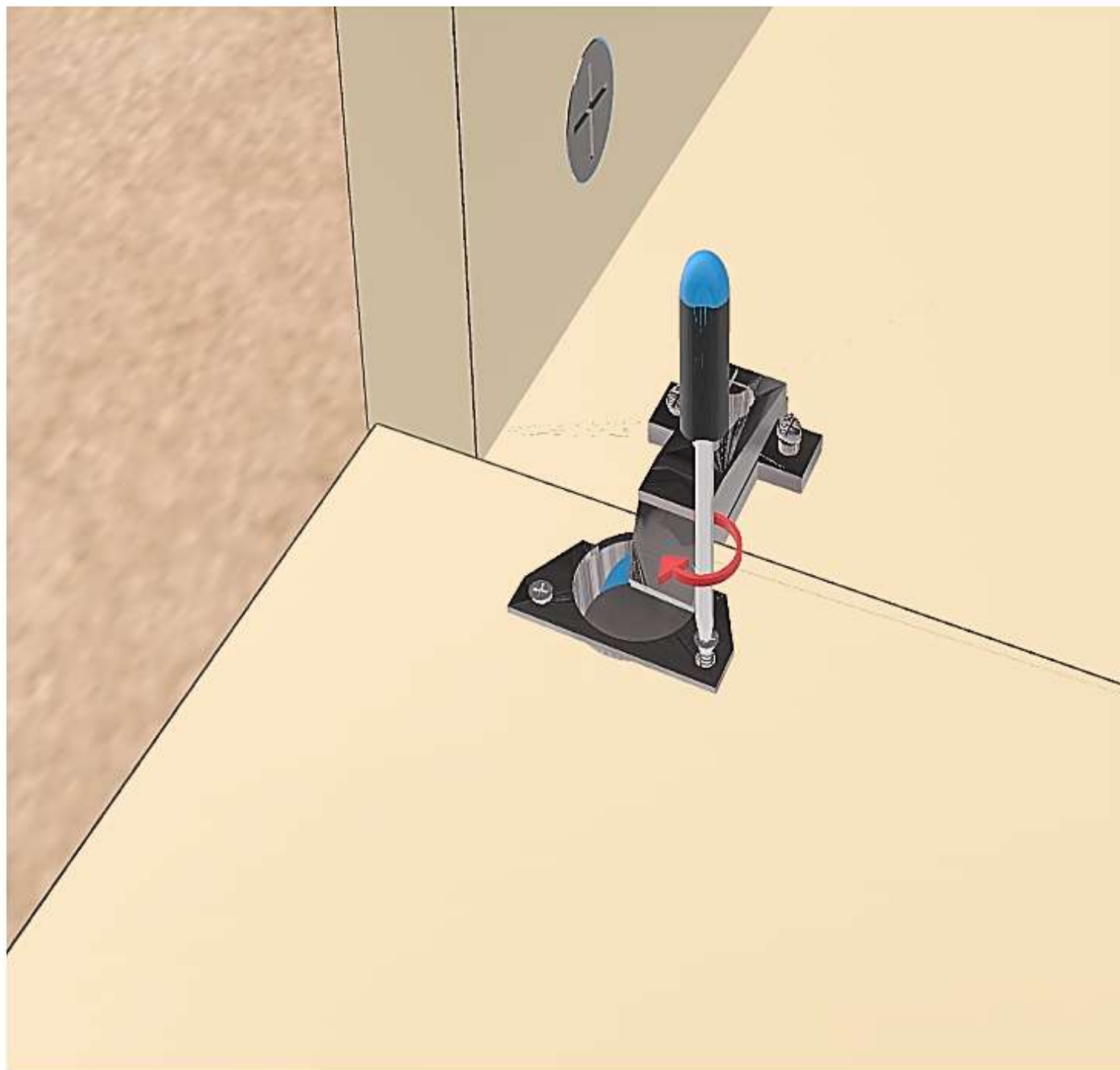

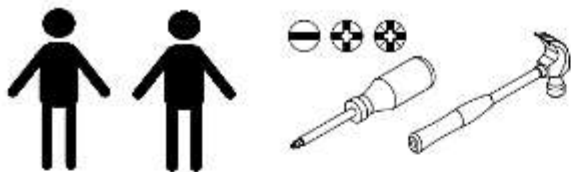

FISSARE LE STAFFE AL MURO CON TASSELLI ADEGUATI

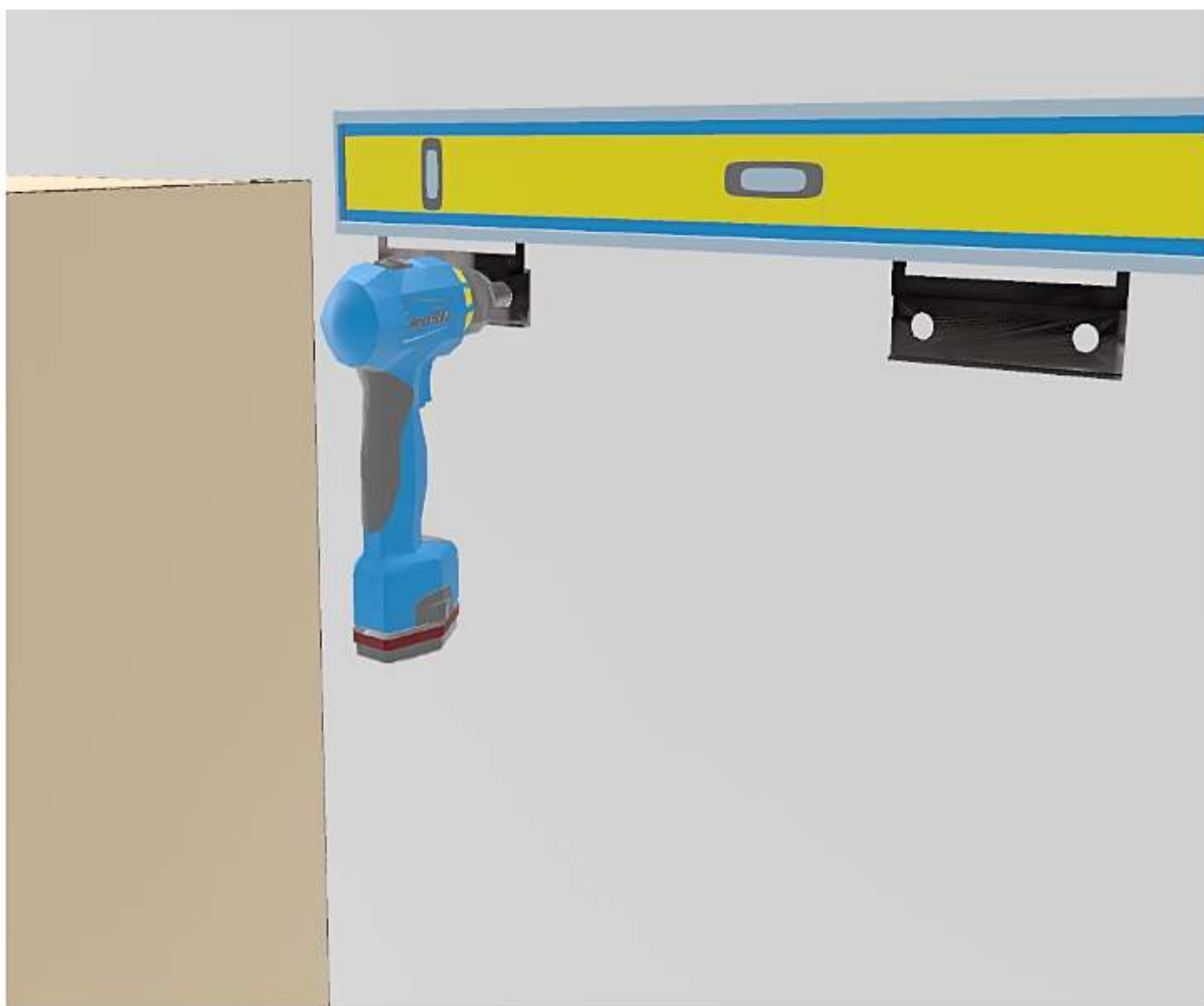

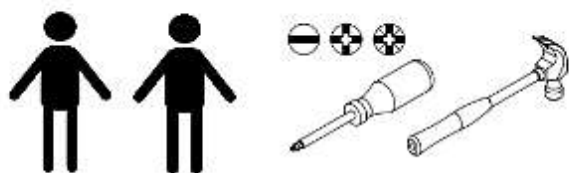

INFILARE IL PUSH PER L'APERTURA DELL'ANTA

