

**Angolo pensile**

**POSIZIONARE I FIANCHI SU DEL CARTONE ED  
AVVITARE I TIRANTI NEI FORI**

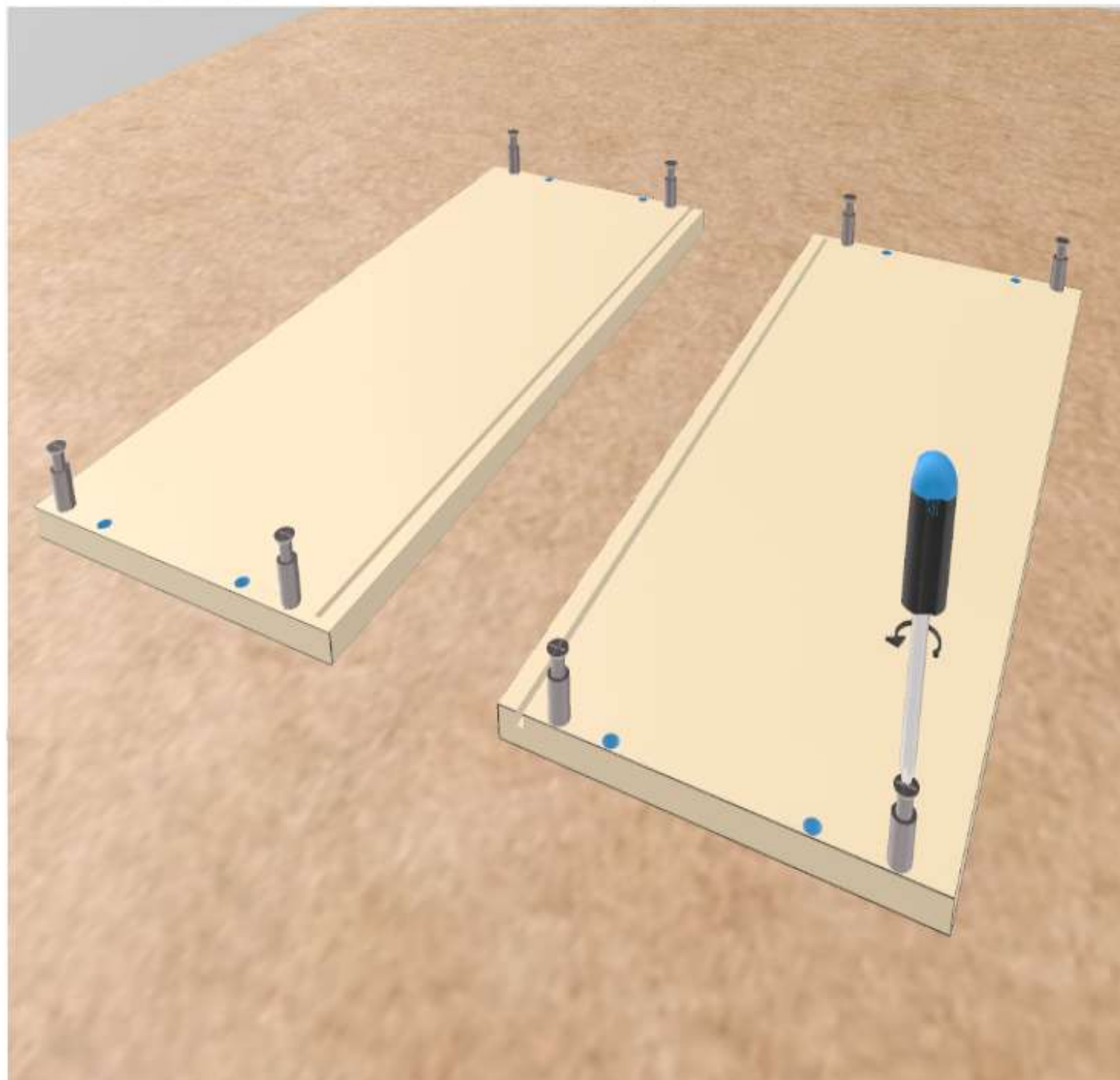

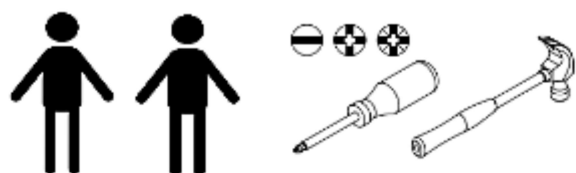

## AVVITARE I TIRANTI ED INCASTRARE LE PARTI

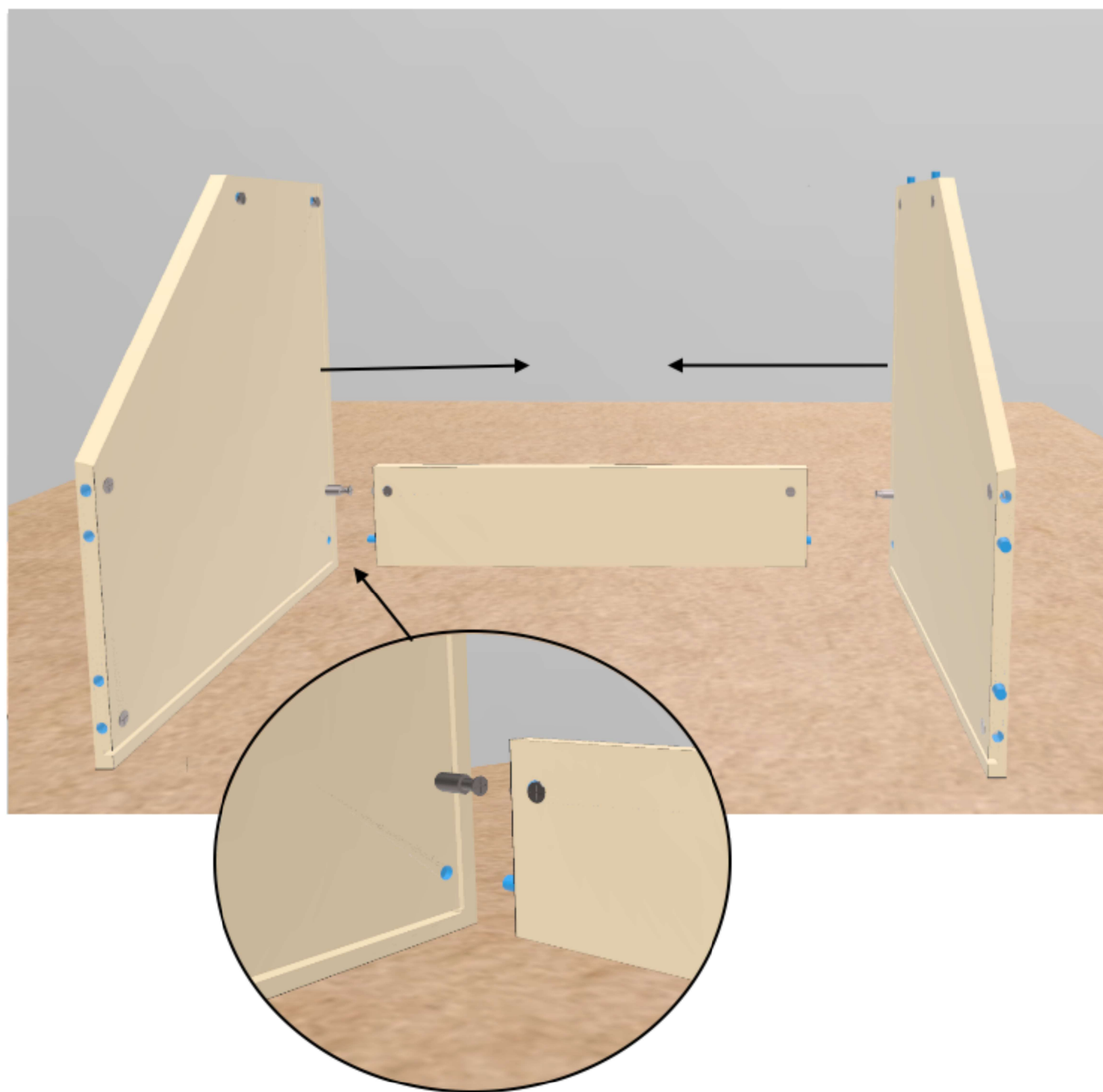

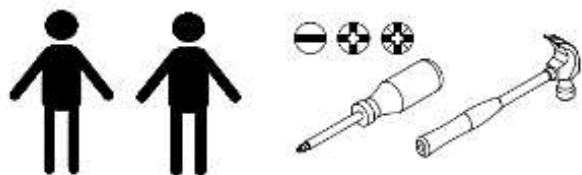

## BLOCCARE LE PARTI

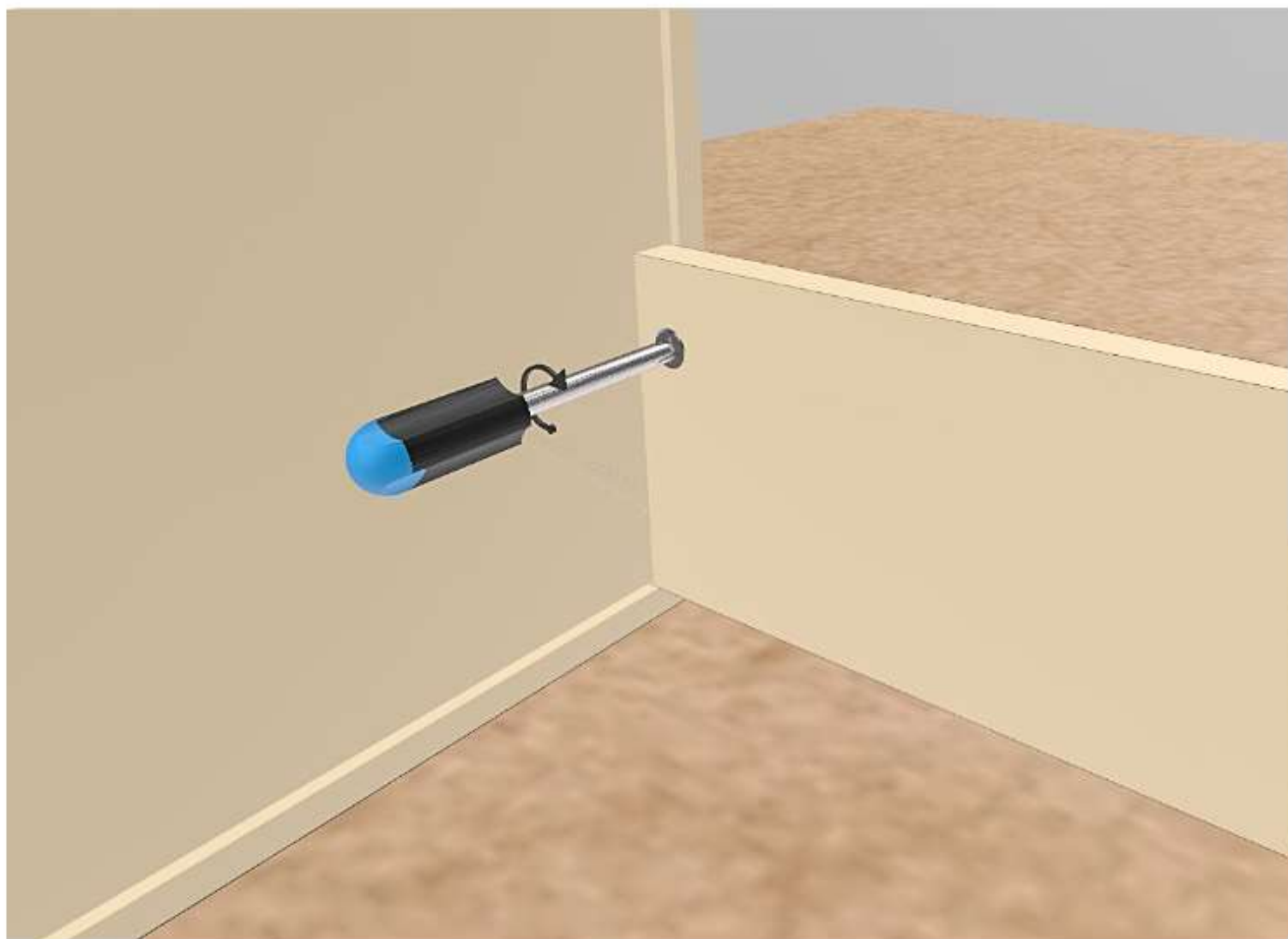

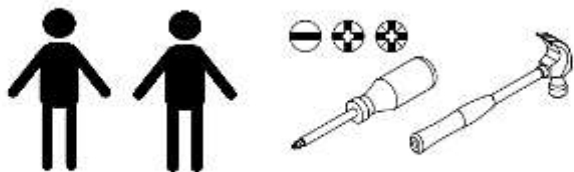

## INCASTRARE I FIANCHI E BLOCCARLI

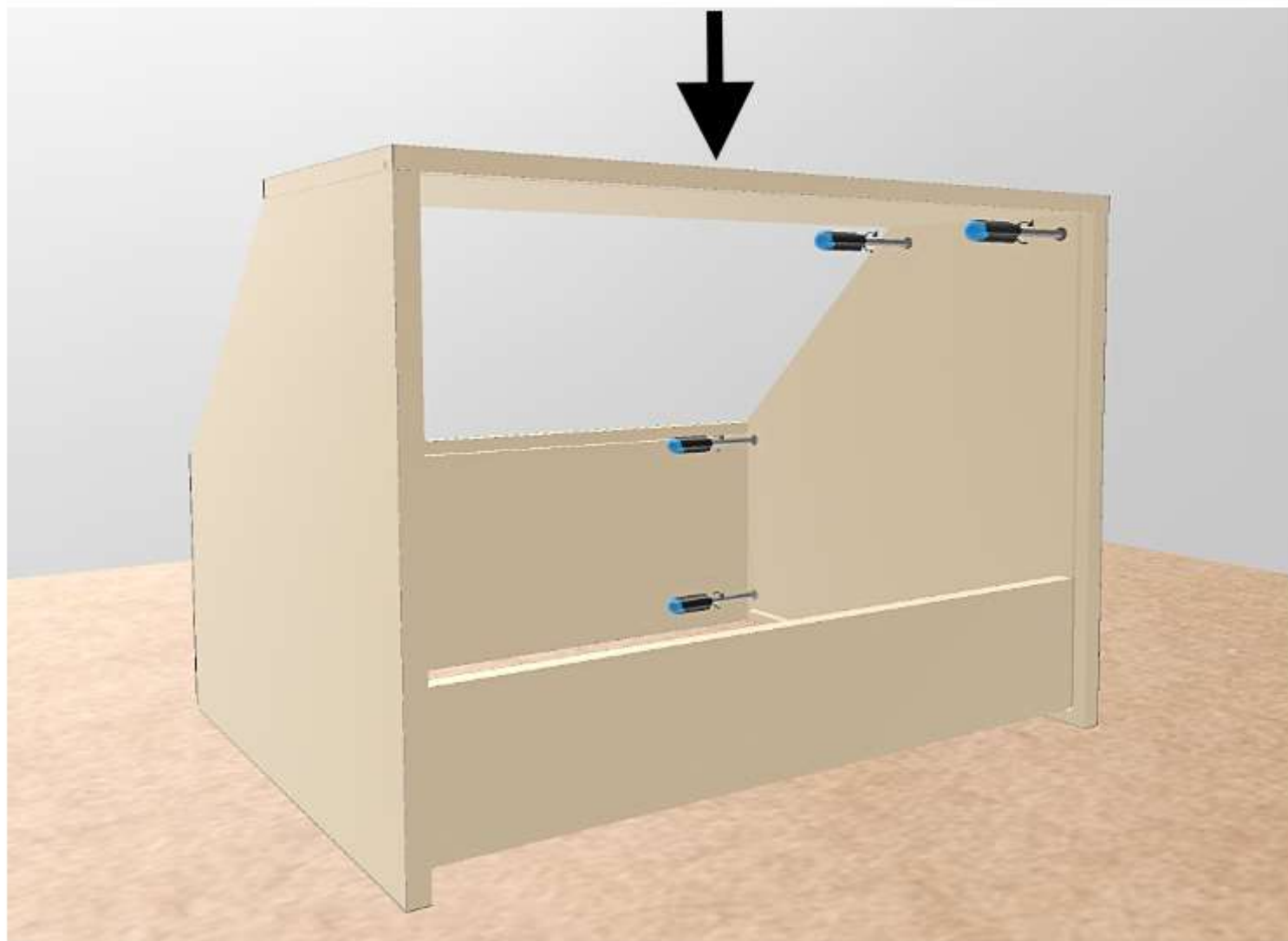

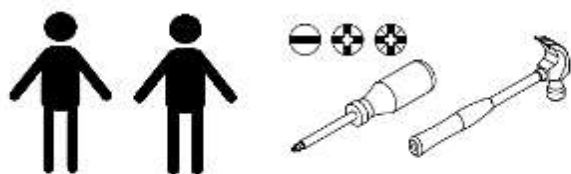

## INFILARE I PANNELLI POSTERIORI ED AVVITARLI

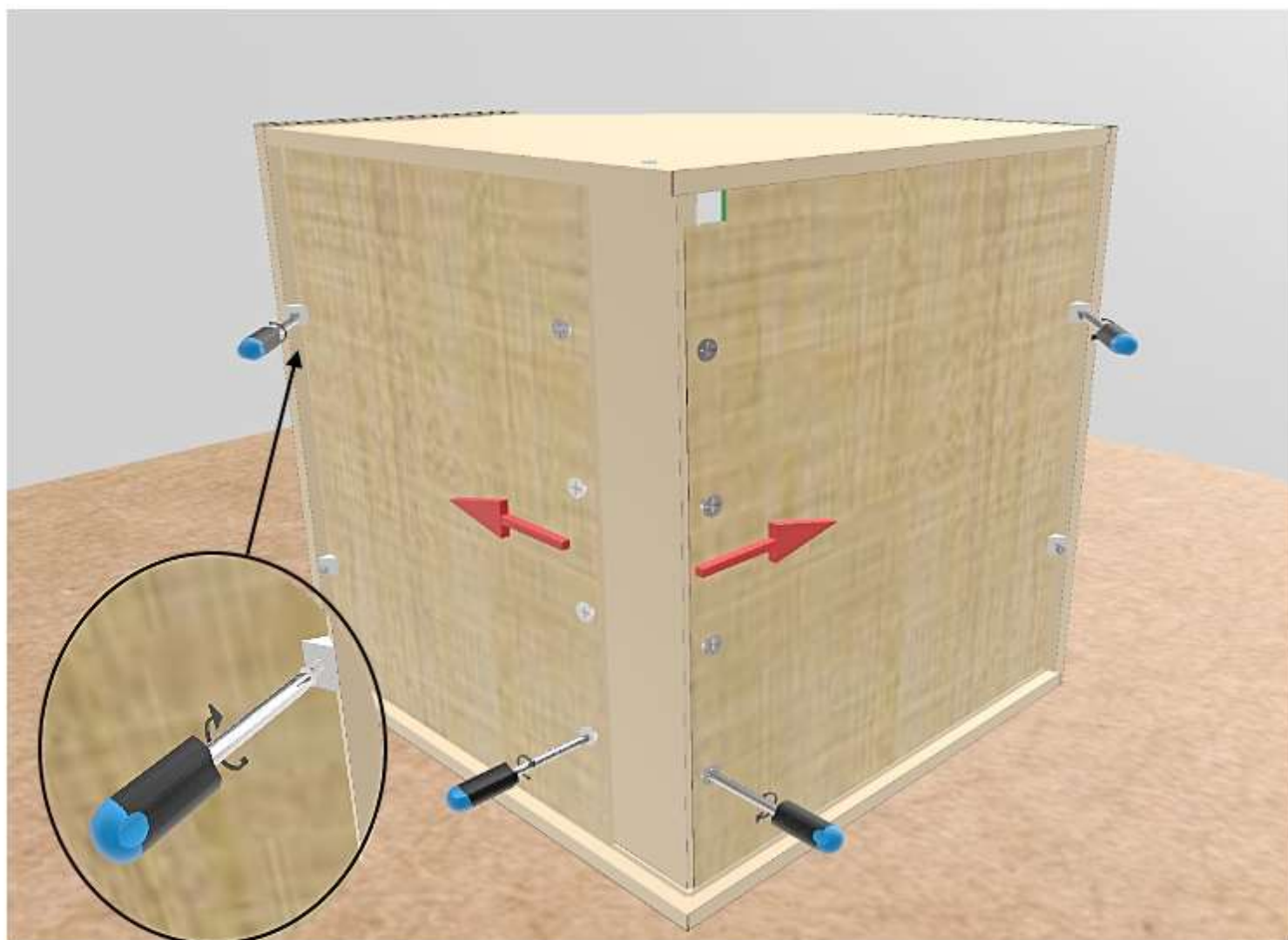





## AVVITARE I SUPPORTI REGOLABILI

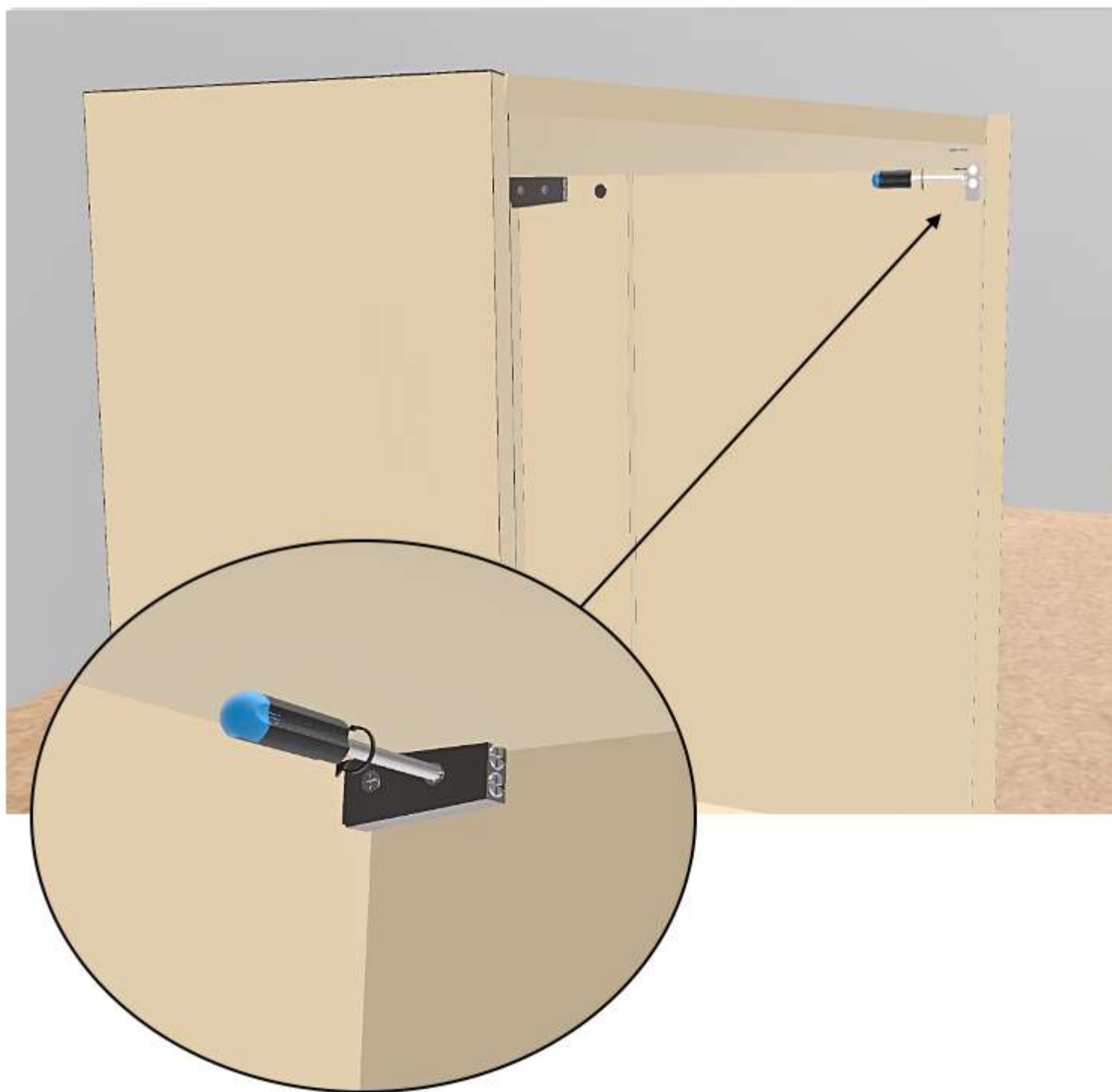

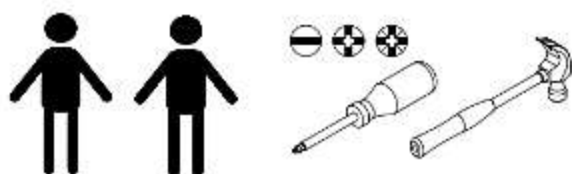

## AVVITARE LE CERNIERE REGOLABILI

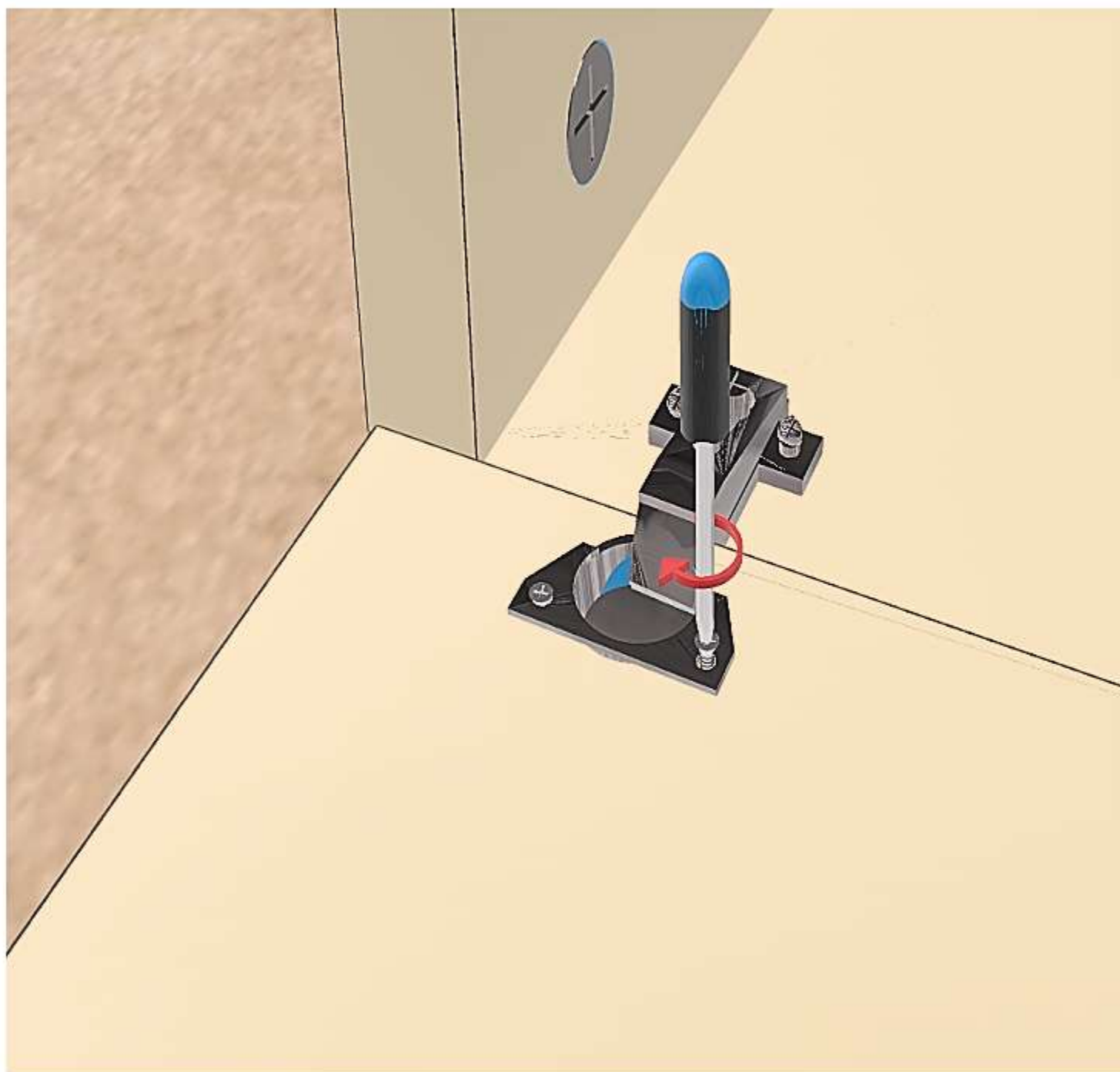

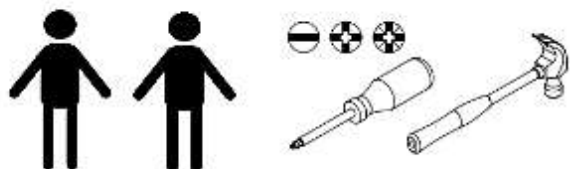

## FISSARE LE STAFFE AL MURO CON TASSELLI ADEGUATI

